

For best results, locate a suitable site for your fountain that is leveled and provides pleasing viewing angles.  
 Note: Always follow local electrical codes and use a 110V GFCI protected outlet.

## 4032F5

1. Locate a suitable site for your **Large Regal Tier Fountain**. Site should be leveled and provide a pleasing viewing angle.
2. Locate the 7032 Basin in the center of your site. Basin must be leveled. Cord relief hole on the 7032 Basin will indicate the back of fountain.
3. Place 6032 Basin on top of the 7032 Base.
4. Connect ADAPTER  $\frac{3}{4}$ "MNPT X  $\frac{3}{4}$ " barb to PS850 Pump and place at bottom of 6032 Basin.
5. **Cord Seal:** the cord seal contains a rubber seal, 4 threaded half plates and 4 screws. Unscrew the four screws and separate the four half plates from the rubber seal. Slip the cord through the split and into the hole in the center of the seal (make sure the narrow end is facing the electrical plug). Reinstall the four half plates with the four screws but do not tighten the screws. Insert the seal assembly fully into the hole in the casting, (leave 6"-8" of cord to the inside of the 6032 Basin) so that it is flush with inside surface and tighten the screws. The rubber seal will expand to seal the hole. Place the rest of the cord through the small hole locate at the bottom of the 7032 Basin.
6. Connect NKT $\frac{3}{4}$ " X 4" Tubing to ADAPTER  $\frac{3}{4}$ "MNPT X  $\frac{3}{4}$ ". Secure the Pump/Tubing connection with the supplied Clamp.
7. Connect both  $\frac{3}{4}$ "NKT X 12" Tubing to  $\frac{3}{4}$ " TEE. This will split the flow going to the top piece and middle Basin. Slip three Clamps to secure tubing on each side of the  $\frac{3}{4}$ " TEE.
8. Place 6035 Basin on its side on top of protected sheets (burlap or excelsior). Connect two Adapters 1"MNPT X  $\frac{3}{4}$ "Barb to bottom of 6035 Basin.
9. Place 6035 Basin on top of 6032 Basin. Attach both pieces of tubing to adapter under 6035 Basin and secure then with Clamps.
10. Center 6035 Basin and connect one ADAPTER 1" X  $\frac{3}{4}$ " BARB to one of the two couplings and a STP1X8 Standpipe to the other coupling. Connect  $\frac{3}{4}$ " NKT X 10" Tubing to the ADAPTER 1" X  $\frac{3}{4}$ " BARB.
11. Connect one ADAPTER  $\frac{3}{4}$ "MNPT X  $\frac{3}{4}$ " BARB to bottom and top of 6034 Basin. Connect the free end of the 10" length tubing to adapter on the 6034 as you place on top 6035.  $\frac{3}{4}$ " NKT X 10" Tubing
12. Connect  $\frac{3}{4}$ " NKT X 4" Tubing to Adapter on top of 6034 Basin. Place 4032 Finial on top of 6034 Basin and slip Tubing through the middle of the 4032 Finial.
13. Fill 6032 Basin with water. Plug Pump into GFCI protected outlet.

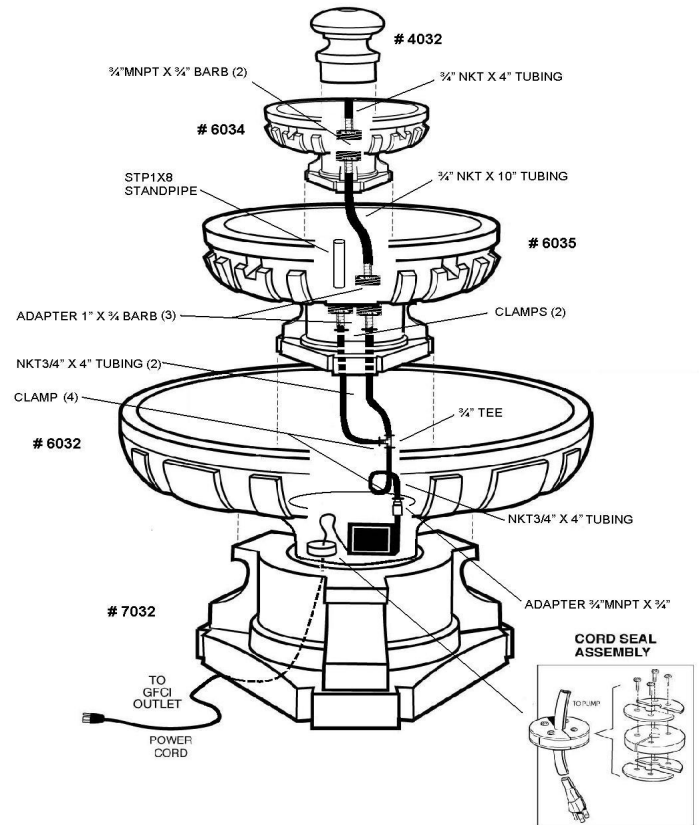

### IMPORTANT - WINTER CARE:

Do not allow water to collect and freeze in fountain bowl(s) or shell(s). Do not allow fountain pieces to sit in a pool of ice. Disassemble entire fountain and pump and store indoors during the winter season.

If you cannot store your fountain indoors during the winter season, you must at least protect it from ice collection or exposure: first, remove the statue(s) and pump, storing them inside if possible. Next, locate the drain plug on the underside of bowl(s) or shell(s). Remove the drain plug to drain any water "trapped" between the walls of the bowl(s) or shell(s). Then fill the bowl(s) or shell(s) with an absorbent material, such as burlap, blankets, etc. Finally, cover the entire fountain with a Henri Fountain Cover. Should condensation droplets form on the inside of the cover, the material will absorb them.

By following these simple and sensible precautions during the winter season, you will protect your fountain for years of beauty and enjoyment!

**CAUTION:** The use of Chlorine or Chlorine Bleach may damage the finish of your fountain. When cleaning your fountain, it is best to test the cleaning agent on an underside or back surface to determine the agent's suitability. We recommend the use of a mild, non-abrasive treatment, such as Henri Lime Remover and Preventer. To avoid foaming, thoroughly rinse the fountain to remove the entire cleaning agent.