



Thank you for choosing Sunnydaze Decor. If you have any questions, comments or concerns please feel free to contact us by phone at: **888-881-4668**, by email: **customerservice@serenityhealth.com**, or you could also email us via our contact us page at: www.SerenityHealth.com/contact_us.php.

We stand behind our brand and the quality of the items we sell. We will send new parts, or replace products at our discretion within the 1-year warranty period. Before we can help, you will need to provide proof of purchase with the date of purchase and photos of the defective merchandise. We will use the photos to determine the cause of defect and for future quality control.

Assembly Instructions for Sunnydaze Ancient Garden Wall Tabletop Fountain w/ Spotlight — Item: XSS-945

- Take the fountain out of the box, so you have two pieces: the top and the bottom.
- Fix the LED spotlight on the backside of the fountain with 2 screws (included) (Step 1).
- Plug the LED spotlight into the adapter that is connected to the pump (Step 2).
- Connect the pump to the tubing on the bottom of the fountain (Step 3).
- Take the cord and place it in the groove that is cut out towards the back side of the fountain (Step 4).
- Put the assembled fountain on the basin (Step 5).
- Put water (1600 ml approx.) in the basin of the fountain (about ½ way full), take all cords and pump, and place it in the water, be sure to make sure there is enough water in the bottom of the fountain so that the pump will be completely submersed (Step 6).
- Connect the adaptor to the pump cable (Step 7).
- Plug the pump in and enjoy (Step 8).

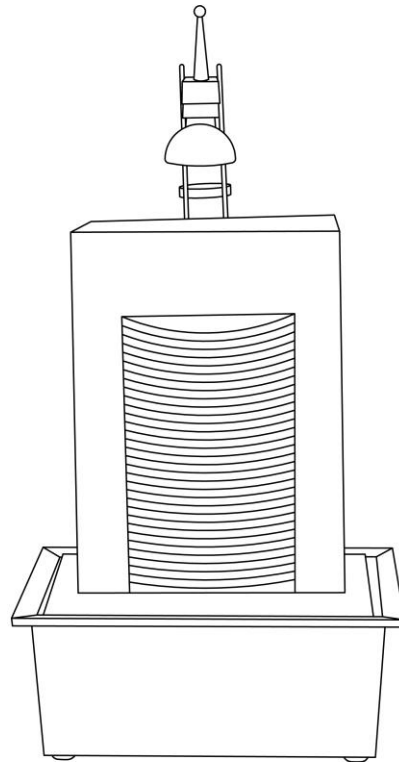
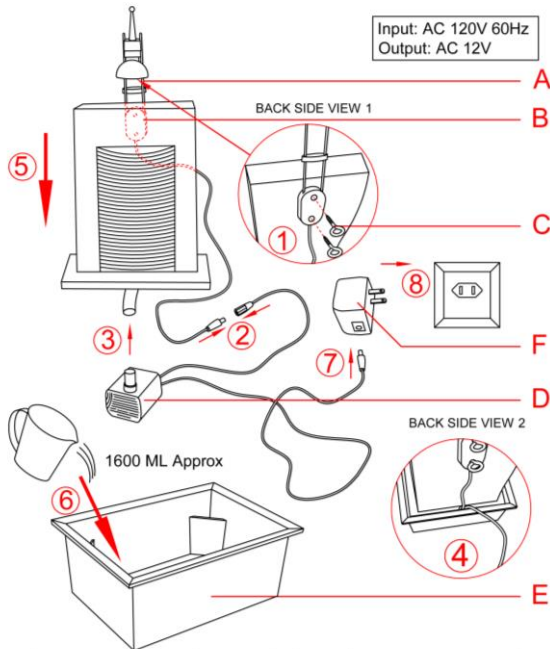

Part	Description	Quantity	Part	Description	Quantity
A	LED spot light	1 pc	D	Water pump	1 pc
B	Fountain Topper	1 pc	E	Fountain base	1 pc
C	Screw	2 pcs	F	Adaptor	1 pc



Be careful not to spill water onto the plug of the pump. DO NOT allow the pump to run dry!