

Thank you for choosing Sunnydaze Decor. We stand behind our brand and the quality of the items we sell. Replacement parts or products will be sent at our discretion, within the one-year warranty period. Proof of purchase, with the date of purchase as well as photos of the defective merchandise, must be provided. If you have any questions, comments or concerns please feel free to contact us by phone at: **888-881-4668**. You may also contact us by email: [customerservice@serenityhealth.com](mailto:customerservice@serenityhealth.com), or via our webpage at: [www.serenityhealth.com/contact-us/](http://www.serenityhealth.com/contact-us/)

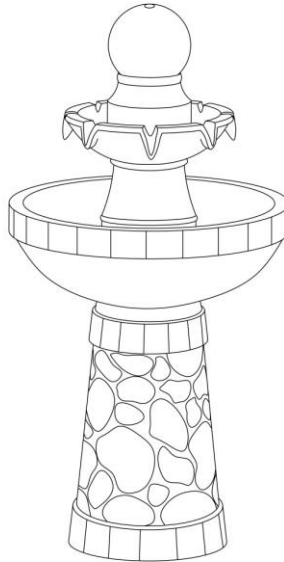

**2-TIER COBBLESTONE LOOK OUTDOOR FOUNTAIN**



PART	DESCRIPTION	QUANTITY	PART	DESCRIPTION	QUANTITY
A	FOUNTAIN TOPPER	1	E	WATER PUMP	1
B	MIDDLE PEDESTAL	1	F	LED ROPE	1
C	FOUNTAIN BASIN	1	G	EVA STOPPLE	1
D	BASE PEDESTAL	1	H	ADAPTOR	1

**ASSEMBLY INSTRUCTIONS:**

**Step 1:** Place the base pedestal (D) and the fountain basin (C) on a level surface, insert the fountain basin(C) into the base pedestal (D) and twist clockwise to lock the fountain basin(C).

**Step 2:** Route the water pump(E)'s power cord out through the plastic tube in the fountain basin(C), lay the water pump(E) in the bottom of the fountain basin(C), and then route the water pump(E)'s power cord through the base pedestal(D), the cord exits through the bottom slot of the base pedestal(D). Lastly insert the EVA stopple(G) in the top of the plastic tube

**Step 3:** Insert, twist and lock the fountain topper(A) to the middle pedestal(B).

**Step 4:** Connect the water tube to the outlet nozzle of the water pump(E).

**Step 5:** Connect the LED rope(F) with the water pump(E)'s shorter power cord, route the LED rope out through the hole on the back side of the middle pedestal(B).

**Step 6:** Insert, twist and lock the assembled middle pedestal(B) and fountain topper(A) to the fountain basin.

**Step 7:** Press both ends of the LED rope in the slots that already fixed in the fountain basin, the LED

**Step 8:** Connect the adaptor (H) to the water pumps power cord.

**Step 9:** Fill the fountain basin (C) and the small basin on the middle pedestal (B) with water. Make sure the water pump (E) is submerged in the water completely.

**Step 10:** Plug the pump in and enjoy the water fountain.

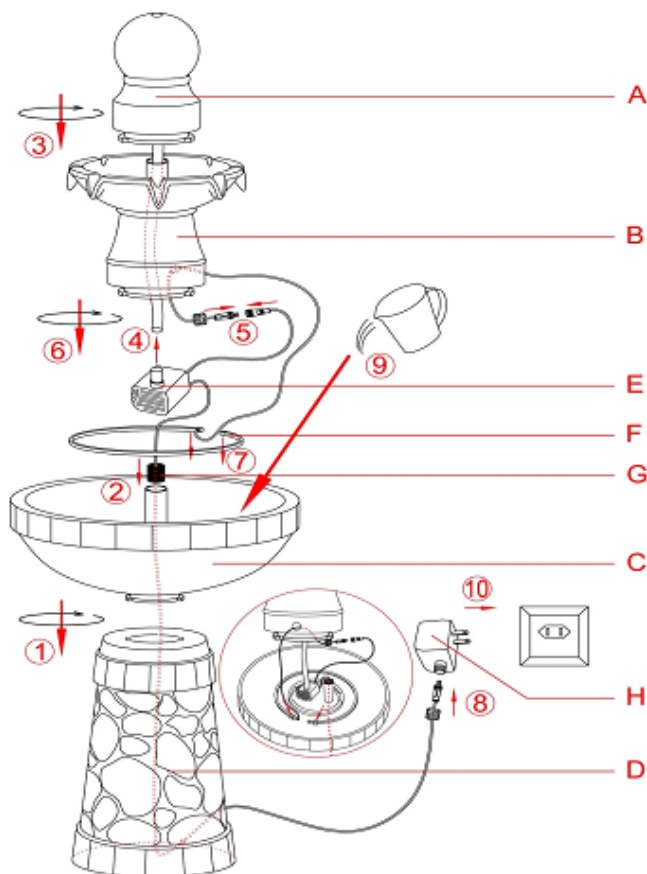

## WARNING



Be careful not to spill water onto the plug of the pump. Create a drip loop with the power cord before plugging. DO NOT allow the pump to run dry.