

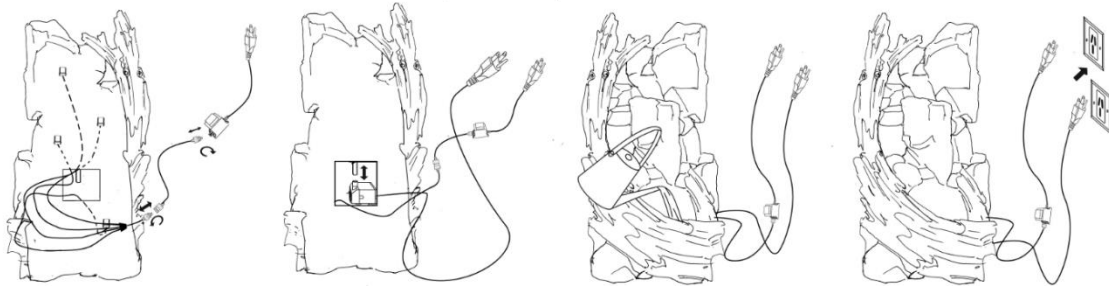

7. Check your fountain area on a regular basis to ensure that there is no leakage.

**Note:** On first use, there may be air in the pump. It may take several minutes until all the air escapes and water begins to flow.



#### **SAFETY GUIDELINES:**

1. Read all instructions and safety guidelines thoroughly. Failure to follow guidelines and instructions could result in serious injury and / or property damage.
2. Do not pump flammable liquids such as gasoline / fuel oil in the fountain pump.
3. Make sure the water tube is properly connected with the pump. Do not crimp the tube as this could cause a blockage and water will not flow.
4. During operation, the pump will be submerged in water. Take care when handling the pump; do not pull it out of the water by the power cord. Do not move the pump while it is still running and submerged in water.
5. Unplug the pump from electric power before servicing, cleaning, or moving.

#### **CLEANING AND MAINTENANCE:**

1. If, after time, the pump starts to lose power or stops working, check for the buildup of sediment or scale in the Fountain Basin.
2. Remove the impediment or any dirt and scale.
3. Periodically change water and keep water clean. Distilled water is recommended to prevent mineral buildup. This will improve the waterfall effect.

**These instructions relate ONLY to this model of water fountain and contain important information for using the product for the first time. Please keep for future reference. These instructions should always accompany the product in the event of transfer to a new user.**