

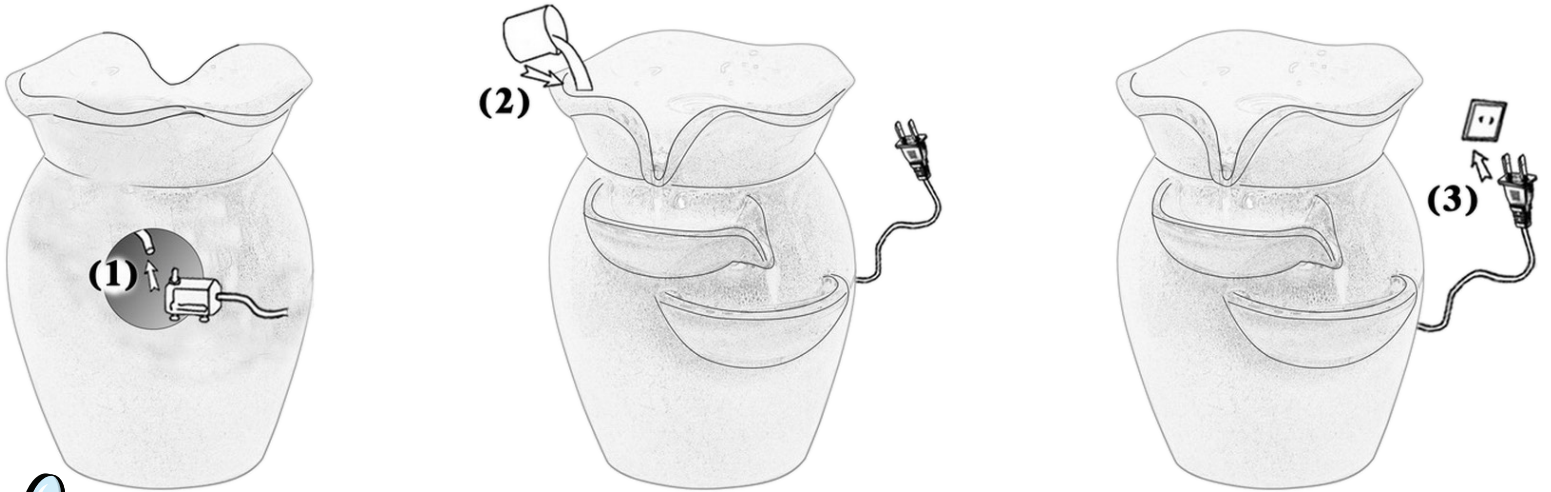

CASCADING SIDE TIERS CERAMIC TABLETOP FOUNTAIN SSS-633

Read the assembly instructions carefully and follow the care instructions. Keep these instructions for future reference.
Assemble components on a soft, clean surface to avoid scratching or damaging the finish.



 **Ensure all parts are accounted for before disposing of packaging.**

PARTS	QTY.
Fountain	1
Electric Submersible Pump	1

NOTE: The water tubing is built into the fountain. Take care when handling the water tube; detaching the water tube will damage the fountain and void the product warranty.

ASSEMBLY

1. Firmly attach the pump to the water tube that is built into the fountain and place the pump inside the fountain, run the power cord out the back of the fountain.
2. Fill the fountain with enough water to keep the pump fully submerged during operation.
3. Plug the power cord into a properly grounded GFCI outlet.

Note: When first used, there may be air in the pump. It may take several minutes for trapped air to escape, allowing water to flow.

⚠ IMPORTANT INFORMATION ⚠

USE & CARE

- For indoor use only.
- Keep fountain out of reach of children and pets.
- Keep power cord away from all heat sources. Do not use electrical cords in areas with high temperatures.
- Check the water level frequently to ensure the pump remains fully submerged; never allow the pump to run dry as it will burn out the motor.
- Only use water in this fountain. Distilled water will help prevent mineral buildup but is not required, avoid heavily chlorinated tap water as it may damage the fountain or pump.
- Periodically change the water to reduce scale and buildup — clean components regularly for optimal performance and appearance.
 - DO NOT use harmful additives such as bleach, chlorine, etc. OR abrasive materials to clean the fountain or pump.
- Always shut off the power supply before cleaning and maintaining the fountain and the recirculating pump.
- Take care when handling the pump; only pick it up by the body of the pump, never by the power cord.

TROUBLESHOOTING

- Ensure that the pump is fully submerged and add water to the reservoir if necessary.
- If water is not flowing within several moments of the fountain being plugged in, the pump may have trapped air which can prevent water from circulating properly. Simply unplug the power supply for a few moments and plug it back in. Also check the pump and tubing for obstructions.
- If water is splashing, check the flow control on the body of the pump; it may need to be adjusted to achieve the desired flow rate.
- Check to make sure the power outlet is working; if in doubt about electrical connections, consult a certified electrician.

Any modification to the product or failure to follow recommended care will void the product warranty.