

SQUARE 2-TIER OUTDOOR BIRD BATH WATER FOUNTAIN WITH LED LIGHTS SSS-337

Read assembly instructions carefully and follow the care instructions. Save these instructions for future reference.

Select a smooth, level surface to place the fountain.

Assemble components of this fountain on a soft, clean surface to avoid scratching or damaging the finish.

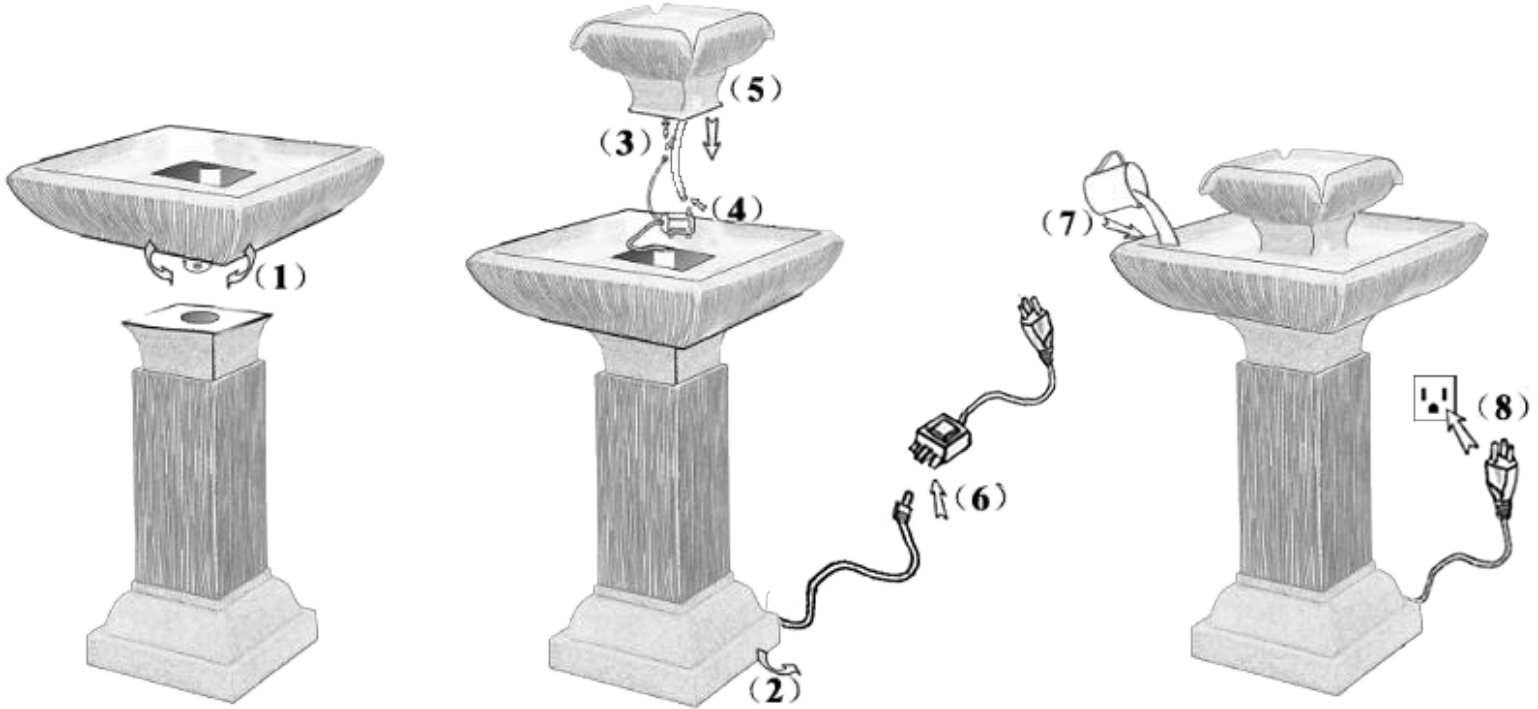

PARTS	QTY.
Topper	1
Bottom Tier	1
Pedestal	1
Electric Submersible Pump	1
Adapter Cord	1



Ensure all parts are accounted for before disposing of packaging.

NOTE: The water tubing is built into the fountain topper. Take care when handling the water tube; detaching the water tube from the fountain will damage the fountain and void the product warranty.

ASSEMBLY

1. Place the bottom tier onto the pedestal and twist clockwise to lock the pieces together.
2. Run the long pump power cord through the tube that is built into the bottom tier, down through the pedestal, and under the groove that is on the bottom of the pedestal.
3. Securely attach the short cable on the pump to the light cable that is built into the topper.
4. Firmly attach the pump to the tubing that is built into the topper.
5. Making sure the pump is laying beside the tube in the bottom tier, gently place the topper onto the bottom tier.
6. Securely connect the pump power cord to the adapter cord.
7. Fill the fountain with enough water to keep the pump fully submerged during operation, approximately 1 gallon.
8. Plug the power cord into a properly grounded GFCI outlet.

Note: When first used, there may be air in the pump. It may take several minutes for the air to escape and water begins to flow.

IMPORTANT INFORMATION

USE & CARE

- For outdoor use only. Some splashing is normal; adjust the flow rate on the pump if the water rate is too high.
- Check the water level frequently to ensure the pump remains fully submerged; never allow the pump to run dry as it will burn out the motor.
- Only use water in this fountain. Distilled water will help prevent mineral buildup but is not required, avoid heavily chlorinated water as it may damage the fountain or pump.
- Periodically change the water to keep the fountain and pump clean. Remove scale and buildup regularly.
DO NOT use harmful additives such as bleach, chlorine, etc.
DO NOT use a pressure washer or abrasive materials to wash the fountain.
- Always shut off the power supply before cleaning and maintaining the fountain and the recirculating pump.
- Take care when handling the pump; only pick it up by the body of the pump, never by the power cord.
- During freezing weather, drain the fountain, disconnect the pump and store indoors; allowing ice to form may damage the fountain in such ways as, but not limited to, the fountain cracking, permanent pump damage, and /or lighting malfunctions.

TROUBLESHOOTING

- Ensure that the pump is fully submerged and add water to the basin if necessary.
- Make sure the pump is not suspended up inside the topper.
- Check the pump and tubing for obstructions.
- Check the flow control on the body of the pump; it may need to be adjusted to achieve a desired flow rate.
- If the light is not working, ensure the cables are fully connected and the seal is adequately tightened (do not over-tighten).
- If water is not flowing within several moments of the fountain being plugged in, unplug the power supply for a few moments and plug it back in; the pump may have trapped air which can prevent water from circulating properly.
- Check to make sure the power outlet is working; if in doubt about electrical connections, consult a certified electrician.

Any modification or failure to follow the recommended care will void the product warranty.